

Tradeshaw profiles

PM profiles



Characteristics

- For the quick and easy assembly of e.g. tradeshow booths and pillars
- Aluminium, anodized
- Manufactured according to DIN EN 12020-2
- Lightweight, sturdy, elegant
- With T-grooves angled 45° for versatility
- Our clamping joints with profile bore-hole and tension elements form very solid, warp-, twist- and bend-resistant connections between the profiles
- Profile cut upon request

Technical specifications

	PM 50	PM 100
dimensions (W x H)	50 x 50 mm	100 x 100 mm
length	2500 mm	3000 mm
weight	1,700 g/m	3,270 g/m
	8 T-groove indentions in an angle of 45° hollow indentation, Ø 8.5 mm for M10	8 T-groove indentions in an angle of 45° hollow indentation, Ø 8.5 mm for M10
inertia moment I_x	12.27 cm ⁴	107.20 cm ⁴
inertia moment I_y	12.27 cm ⁴	107.20 cm ⁴
moment of resistance W_x	4.91 cm ³	21.44 cm ³
moment of resistance W_y	4.91 cm ³	21.44 cm ³

Order data

Profile name	Item no.: L=2500 mm Item no.: L=3000 mm
PM 50 W 50 x H 50 mm	200004 2500
100 PM W 100 x H 100 mm	200005 3000

Scale drawings

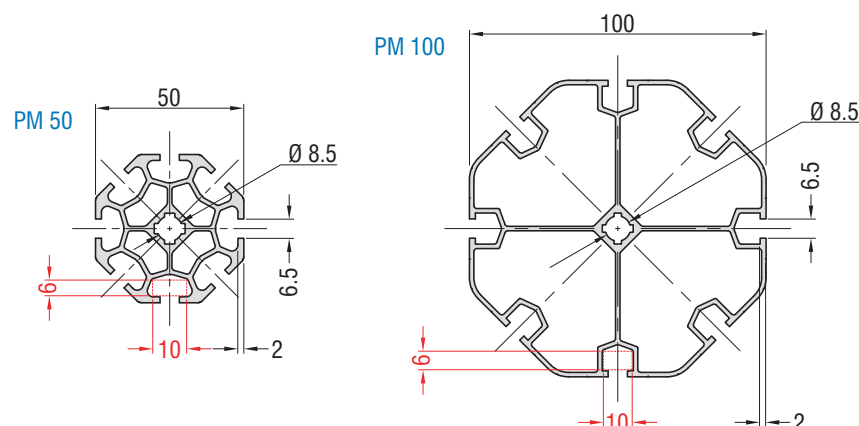

Technical specifications subject to change.