

# Linear units with toothed belt drive

## LEZ 1

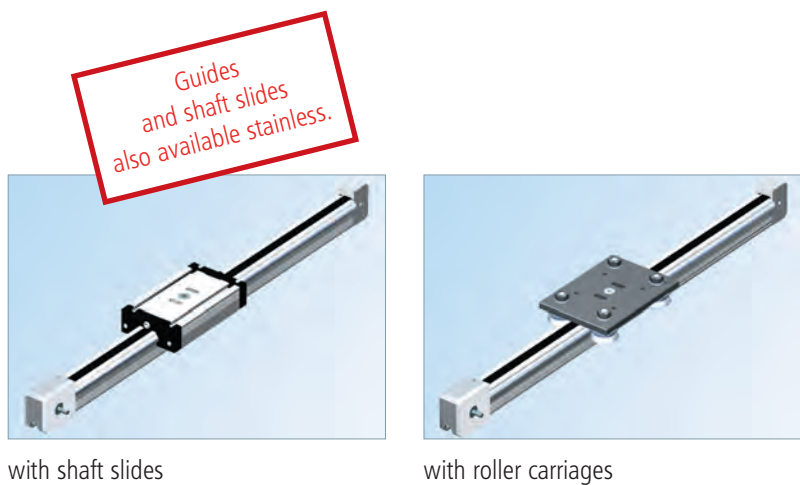

### Features

- Aluminium profile, miniature linear guide LFS-8-2
- no-play feed with toothed belt drive
  - toothed belt with 3 mm interval
  - Width 9 mm
- Feed per turn: 60 mm
- Repeatability less than or equal to  $\pm 0.2$  mm
- Max. feed. 1,5 m/s
- Limit or reference switch accuracy < 0,1 mm (with drive modules)

Accessories are on page C98.

### Options:

- special lengths in 100 mm raster to order, max. 6000 mm
- Also available as direct drive with
  - step motor
  - DC servo motor
- Overrun limit switches with connecting cable (only in combination with integrated drive module)

### Ordering key

232 005 XXXX

|                         |                                     |
|-------------------------|-------------------------------------|
| <b>Drives/Slides</b>    | <b>Profile lengths LFS-8-2 (mm)</b> |
| <b>Roller carriages</b> | 298, 398, 498, 598, 675,            |
| 8 = without motor,      | 698, 798, 998, 1498, 1798,          |
| with shaft slides       | 1998, 2498, 2998                    |
| 9 = without motor,      | (e. g. 398 mm = 040                 |
| with roller carriages   | 675 mm = 068)                       |
|                         | Option: up to 6000 mm               |

### Technical specification

|  |  |
|--|--|
| Belt type.....                                   | HTD 3M, width 9 mm                     |
| Slide weight.....                                | 0.430 kg                               |
| Weight without drive module.....                 | 1000 mm = 3 kg                         |
| specific weight of the toothed belt.....         | 0.0225 kg/m                            |
| Roller carriage weight.....                      | 1.03 kg                                |
| specific guide weight.....                       | 0.200 kg/100 mm                        |
| Effective diameter of the synchronous disks..... | $\varnothing 19.10$ mm                 |
| Moment of inertia of the synchronous disks.....  | $5.585 \cdot 10^{-7}$ kgm <sup>2</sup> |
| Feed per turn.....                               | 60 mm                                  |

### Load diagram

Permitted accelerated weights relative to the belt strength.\*

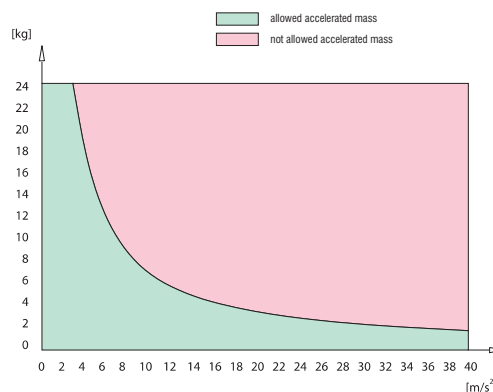

\* with vertical construction, the acceleration due to gravity ( $g = 9.81 \text{ m/s}^2$ ) must be taken into account

Bending data is on page C 23.

# Linear units

with toothed belt drive

## LEZ 1

### Dimensioned drawings

without motor, with shaft slides

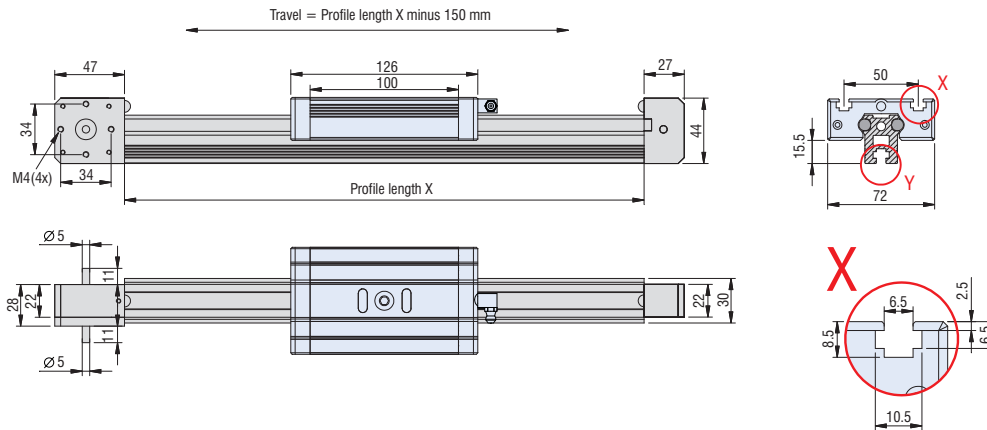

### without motor, with roller carriages

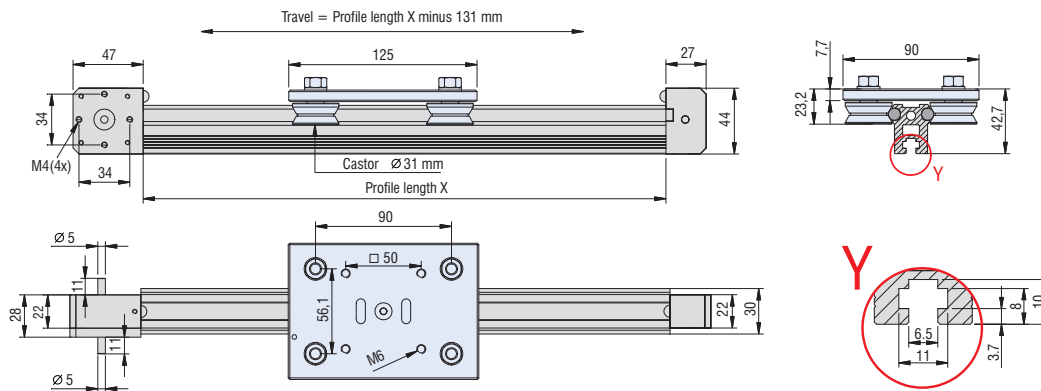

### Motor modules (Motor pin assignments are on page C74.)

Drive module with step motor  
MS-045 HT (direct drive)  
Feed: 60 mm/turn

Part no.: **396048 3015**

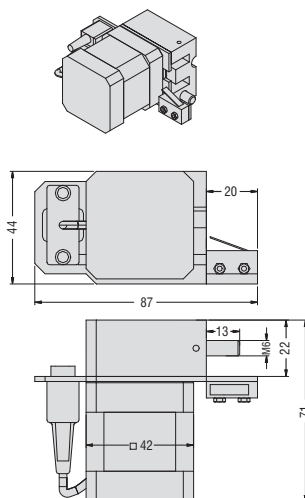

Drive module with step motor  
MS-045 HT (reduction 2:1)  
Feed: 30 mm/turn

Part no.: **396049 3015**

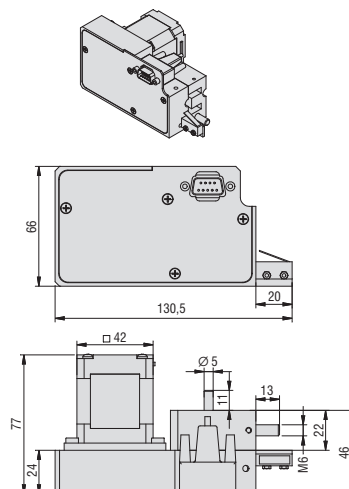

Drive module with step motor  
MS-135 HT (reduction 2:1)  
Feed: 30 mm/turn

Part no.: **396056 3015**

