

Linear unit with belt drive

LEZ 9

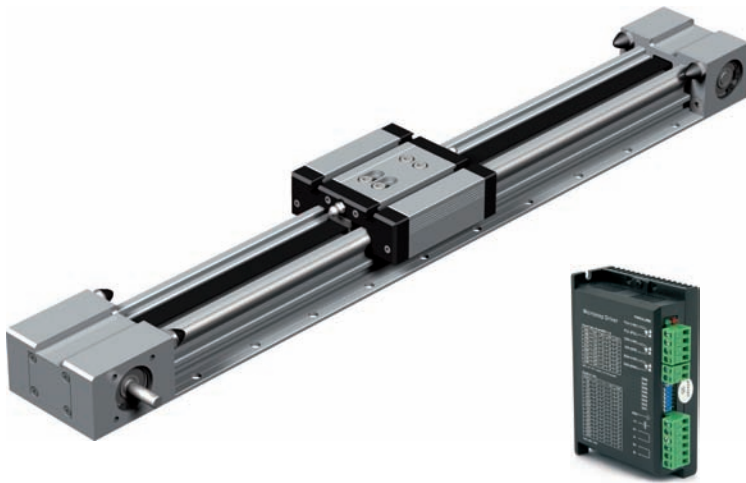

Figure:
Drive unit MD 24

Characteristics

- Backlash-free feed with belt drive
- Aluminium profile, Linear guide LFS-8-7
- Toothed belt with 3 mm gapping
Width 15 mm
- Repeat accuracy smaller or equal ± 0.2 mm
- Feed max. 2 m/s
- Shaft slide WS 11
L 96 x W 95 mm

Options:

- Special lengths in a grid 100 mm
- Stepper Motor or servo motor
- Drive control

General

The linear units in the LEZ series with toothed belt feed feature a modular set-up and are suitable for quick positioning in the area of installation automation and machine handling. Due to their sturdy and rigid aluminium constructions they are primarily used where work pieces need to be processed or transported.

The patented shaft slides with ball races are used as guide slides. All LEZ series linear units can also be supplied with the matching drive units as well as special connecting angles, allowing various combinations in cross, H-, and multi-axe configurations.

Technical specifications

Belt type	HTD 3M, width 15 mm
Slide weight	0.4 kg
Weight without drive unit	1,000 mm \wedge = 4.4 kg
Specific mass of the toothed belt	0.04 kg/m
Specific guide weight	0.29 kg/100 mm
Effective diameter of the synchronised pulleys	\varnothing 19.1 mm
Mass inertia moment of the synchronised pulleys	$5.86 \cdot 10^{-6}$ kgm ²
Theoretic feed per rotation	60 mm

Order data

Without drive:

- Item no.:** 232010 0100 L = 996 mm
Item no.: 232010 0300 L = 2996 mm

With stepper motor:

- Item no.:** 232010 10005 L = 996 mm
Item no.: 232010 30005 L = 2996 mm

With stepper motor and drive unit:

- Item no.:** 232010 0100055 L = 996 mm
Item no.: 232010 0300055 L = 2996 mm

Scale drawings

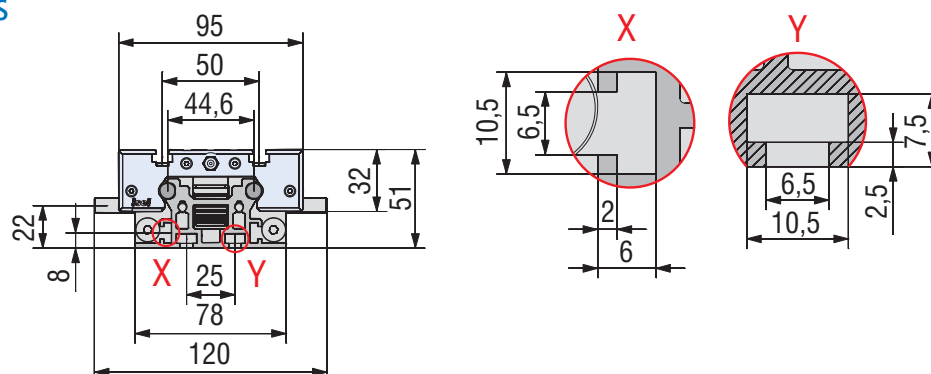

Technical specifications subject to change.